

# Turbulator Range

High Quality Recirculation Fans

# hydor

Phone 1300 655 730



Hydor Turbulator fans are specifically designed to have a long throw and move air efficiently to give a measure of control over temperature and humidity in glasshouses, polythene tunnels, poultry, turkey, calf and pig housing, potato stores and industrial buildings.

The Turbulator gives sufficient light air movement to counteract the effects of still air conditions, by improving air distribution, reduce air temperature stratification, increase air velocity in the plant / animal zone and eliminate dead air spots.

## Glasshouse and Polythene Tunnels

Depending on the size and shape of the glasshouse and height of the crop, a number of horizontally mounted Hydor Turbulators will provide the required air movement over the whole area at minimal consumption of electricity. The units will also ensure a thorough distribution of CO<sub>2</sub>. Plastic tubes can easily be fitted to the outlet of the fan if more positive air distribution is required.

## Livestock Housing

When Hydor Turbulators are used for redistribution of air in livestock buildings the units are fitted with a special deflector plate which directs the air to the sides of the building. The units are mounted either horizontally or vertically and when used for heat redistribution, the fans suck downwards from the apex area, forcing the hot air from the apex out to the sides and recirculating back towards the centre. In summertime the fans are lowered by means of pulleys to force air downwards along the centre of the house, thus creating turbulence and redistributing the lower strata of air.

## Crop Stores

For potato storage a polythene tube is fitted to the vertically mounted Turbulator units which brings the air from high level to localised low level and achieves even temperature and humidity.

# Turbulator Range

High Quality Recirculation Fans



Phone 1300 655 730

## Performance & Electrical Data

| Product Code | Fan Dia. | Speed RPM | Airflow m <sup>3</sup> /s | Throw Metres | Motor Electrical Data 220-240V / 1Ph / 50Hz |           | Sound Level dB(A) @ 3m |
|--------------|----------|-----------|---------------------------|--------------|---|-----------|------------------------|
|              |          |           |                           |              | FL Amps                                     | Output kW |                        |
| TUR1841      | 450      | 1350      | 1.701                     | 40-45        | 1.9   | 0.26      | 64                     |
| TUR2461      | 630      | 900       | 2.863                     | 45-50        | 2.1   | 0.33      | 60                     |

## Features



- Alu-Zinc coated steel duct supplied with suspension eyes and chain for ease of mounting
- Rust proof wire inlet and outlet guards
- 240V, 1 Phase IP 55 Motor
- Waterproof junction box and lead
- Air straighteners assist long throw distance
- Automatic and manual infinitely variable controllers available
- Can be controlled by electronic/manual thermostats

## Dimensional Data

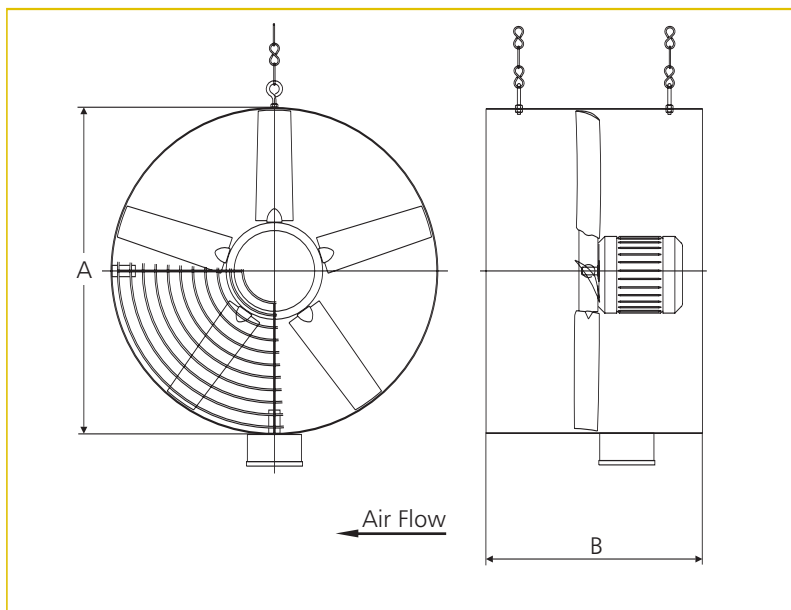

|       | A   | B   | Weight Kg |
|-------|-----|-----|-----------|
| TUR18 | 460 | 420 | 15        |
| TUR24 | 660 | 630 | 29        |

## Contact Us



Mail: P.O. Box 1075, Mt. Waverley 3149, Victoria, Australia  
 Phone: 1300 655 730  
 Fax: 1300 134 319  
 Email: [info@hydor.com.au](mailto:info@hydor.com.au)  
 Web: [www.hydor.com.au](http://www.hydor.com.au)